

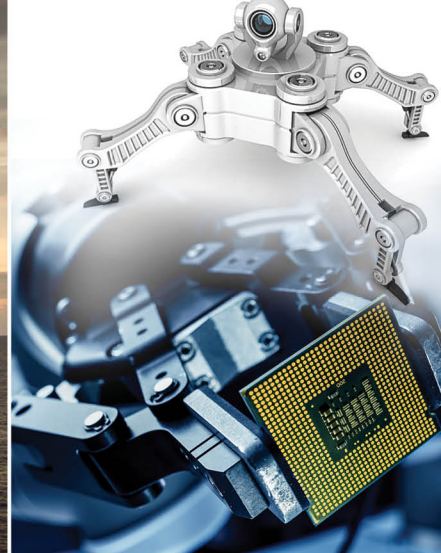

ALUMINIUM
STAINLESS STEEL
TITANIUM





INDEX

| | |
|---------------------------------|-------|
| About Us | 1 |
| How to Order | 2 |
| Material Information | 3-5 |
| Product Profiles | 6-9 |
| PRO-BOLT ALUMINIUM | |
| Bolts | 10-12 |
| Nuts & Washers | 13 |
| PRO-BOLT STAINLESS STEEL | |
| Bolts | 14-15 |
| Nuts & Washers | 16 |
| PRO-BOLT TITANIUM | |
| Bolts | 17-19 |
| Nuts | 20 |
| Washers | 21 |
| PRO-BOLT ANCILLARY ITEMS | |
| Ancillary Items | 22-23 |

ABOUT US

Pro-Bolt is the world's leading supplier of high quality fasteners and has earned a reputation for excellence in supply, high quality and support from its work in the extremely demanding world of British Superbikes, World Superbikes and MotoGP. Our performance in the paddock means that users from other industry sectors, who need lightweight, high quality and performance fasteners, fit Pro-Bolt. Customers fit and forget with Pro-Bolt.

Based in the UK's Motorsport Valley, Pro-Bolt benefits from easy access to industry innovators and expertise. This, coupled with the knowledge we gain during our bespoke developments for racing clients, keeps our product range at the cutting edge of what is possible.

We couple innovative design and technical expertise with great looks and well thought through product ranges.

HOW PRO-BOLT'S CUSTOMERS HAVE HELPED US GROW

Our customers use our products in extreme conditions and constantly feed back to us their ideas for improvement, new requirements and application demands. By listening to this feedback we are able to keep our product ranges in line with our customers' needs.

PRO-BOLT'S QUALITY ASSURANCE

Our products are of superior quality because they are manufactured using fully certified and traceable raw materials, enhanced using multi-axis sliding head machines to ISO9001:2015 standards and then anodised by our in-house experts. We carry high stock levels so that when you need to complete your project, or replace critical parts, we can meet your deadlines.

BESPOKE MANUFACTURE

If what you need is not a stock item we will make your parts quickly, using the same high quality materials and processes we use in our standard range, so that you can enjoy the same service and peace of mind, wherever your project takes you.

WORLDWIDE SUPPLY

Pro-Bolt supply more than 50 countries globally, offering multi-currency purchasing, local distribution and support, as well as UPS delivery, all designed to help you complete your projects on time, every time.

PERSONAL SERVICE COMMITMENT

Dedicated team for B2B, flexible when you need us to be and provide a service which delights you.

OUR CLIENTS

As the world's leading supplier of high quality, high performance and quality assured bolts and fasteners Pro-Bolt's products are everywhere, in space on satellites, in the sky on helicopters & UAVs, at sea and in homes. The following companies fit Pro-Bolt and benefit from light weight fittings, extreme performance tolerances and our perfect finish.



HOW TO ORDER

■ ORDER ONLINE

View our range of unique fasteners along with basic dimensional information all available from stock. Please speak to business development team to get setup enabling you to order on-line.

Our Global Website: www.pro-bolt.com

■ DELIVERY OPTIONS

We aim to deliver from stock in 1-2 days, but please allow 3 days before progressing your order. Delivery Options available are:

- Orders placed using 1st / 2nd Class Post are not traceable and Pro-Bolt is not responsible for loss in transit or non-delivery;
- Royal Mail Signed for: Signed Proof of Delivery is available once delivered, but is non-traceable during transit;
- Courier: Fully traceable courier service;
- Guaranteed Next Day: Deliveries before 9.30am and/or 1pm are available depending on delivery address;
- Royal Mail: Saturday before 1pm. depending on delivery address;

■ TALK TO US

Office hours: Monday-Thursday 8.30 - 5.00 Friday 8.00 - 4.00

(Answerphone out of hours; all times GMT)

Telephone: +44 (0) 1684 851940

E-mail: sales@pro-bolt.com

■ VISIT US

Come and meet us by visiting our UK office, which is located at: ProBolt Fasteners Ltd, Unit 9d, Delta Drive Industrial Estate, Tewkesbury, Gloucestershire, GL20 8HB, UK.

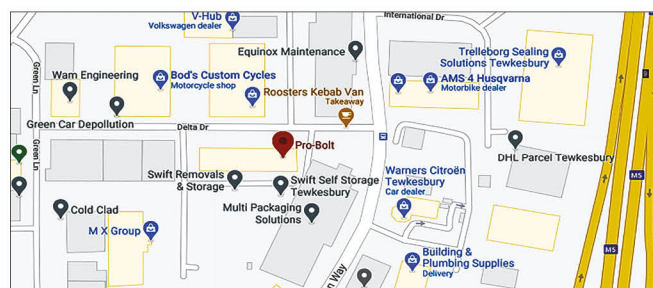

■ COMMERCIAL CUSTOMERS

Pro-Bolt has built its reputation by providing excellent quality products and first class customer service. We supply into a wide range of commercial markets globally and are able to accommodate most requests. We can offer customised stationary, incorporate our customer part numbers etc. Whatever the size of your project we would be happy to provide a quotation on request.



■ PAYMENT METHODS

Credit or Debit Cards: Please have your card ready. We accept MasterCard, Visa, and American Express.

Money Orders / Bank Drafts: On receipt of a Pro-Bolt pro-forma invoice, please send payable to 'Pro-Bolt' quoting your order number.

PayPal: We can accept payment by PayPal – please ring for details.

Bank Transfers: Pro-Bolt are able to offer pricing in Pounds Sterling, Euros or US Dollars – please contact us for relevant information.

■ PRICE LISTS AND FITMENT GUIDES

This catalogue is supplied with a separate Price List giving prices for individual bolts, packs, boxes and kits. Due to volatile material prices, Pro-Bolt reserves the right to change prices and discontinue products without notice. All retail prices in our Price List include VAT and are in Pounds Sterling. VAT will not be charged to retail customers outside of the EU. VAT will not be charged to registered business outside the EU, or within the EU if a valid VAT number is provided on placement of order.

Product lists and price lists can be provided as excel exports on request. We can offer pricing in GBP, USD, EURO & AUD

■ PRO-BOLT COPYRIGHT

Pro-Bolt is a registered trade mark. Photography and the information present in this catalogue are the property of Pro-Bolt. All rights are reserved.

■ JOIN OUR COMMUNITY

If you enjoy social networking, be the first to find out about our latest products and events by becoming a fan on Facebook. Our social networks provide exclusive images from the paddocks - including MotoGP, Moto2, Moto3, World Superbikes, World Supersport and British Superbikes. Our range is constantly evolving with new products which are regularly added to our website and broadcast on



Facebook: ProBolt



Twitter: Probolt



Instagram: proboltuk



YouTube: ProboltUK



Linkedin: probolt-fasteners-ltd

MATERIALS

ALUMINIUM

ALL AVAILABLE IN A CHOICE OF 7 COLOURS:
BLACK • BLUE • GOLD • ORANGE • PURPLE • RED • SILVER

Lightweight, colour consistent and machined to a high quality smooth finish, our ever increasing aluminium range allows you to create a unique look and style.

All our fasteners are available in a choice of black, blue, gold, orange, purple, red and silver.

- **Material specification:** 7075-T6 Aluminium
- **Manufacturing process:** Head: cold formed; Shank: thread rolled
- **Anodising:** Chemically brightened and colour anodised to between 8 and 12 microns thick
- **Weight:** 60% lighter than steel – 40% lighter than titanium
- **Corrosion:** Saltwater, road film or mild acids do not affect anodised aluminium
- **Application:** Aluminium is suitable for use in all non-safety critical areas – mudguards, screens, fairings, engine casings, huggers, fuel caps, number plates, lamp units, exhaust cans, heel plates, exhaust manifold brackets, fuel cap surrounds, air filters, car rocker covers, plus many more. Aluminium is not suitable for any stress area applications. If you are in any doubt as to the suitability of our products for your machine, or the size you need, please contact Pro-Bolt directly.

ANODISED PRODUCTS

The colour finish applied to our products is known as 'anodising'. This is an electrochemical conversion process that permanently changes the outer structure of the metal. When aluminium is exposed to air it naturally develops a thin aluminium oxide film that seals the aluminium from further oxidation. Its porous nature makes it possible to dye the aluminium a variety of colours.

MATERIAL PROPERTIES

- Density:2730 kg/m³ (170lb/ft³)
- Young's Modulus:72GPa (10.4 x 10⁶psi)
- Yield Strength:.....505MPa (73.2 x 10³psi)
- Ultimate Tensile Strength:.....570MPa (82.7 x 10³psi)
- Compressive Strength:.....505MPa (73.2 x 10³psi)
- Shear Modulus:27GPa (3.92 x 10⁶psi)
- Shear Strength:330MPa (47.9 x 10³psi)

- Ductility:10% elongation at break
- Poisson's Ratio:0.33
- Hardness:150 Brinell
- Strength-to-Weight Ratio:.....185 kNm/kg
- Stiffness-to-Weight Ratio:.....26.4 MNm/kg

| Thread Diameter | Material Tensile Stress Area (mm ²) | Max Load (kN) | Total Elongation (mm) |
|-----------------|---|---------------|-----------------------|
| M6 | 20.1 | 11.58 | 0.56 |
| M8 | 36.6 | 23.19 | 0.62 |
| M10 | 58.0 | 39.17 | 1.05 |

TORQUE & LUBRICATION

When individual bolts are purchased, torque guides vary depending on the material, manufacturing method, thread diameter, pitch and head style. *We recommend the below setting for Pro-Bolt products.

| Maximum Torque Guide - Aluminium in Nm | | | | | | |
|--|------|------|------|------|-------|-------|
| Thread Diameter | M3 | M4 | M5 | M6 | M8 | M10 |
| Flanged Hex Head Bolt | n/a | n/a | 6.00 | 8.00 | 12.00 | 20.00 |
| Socket Cap | 1.50 | 3.50 | 6.00 | 6.00 | 10.00 | n/a |
| Dome Head/Fairing Bolt | n/a | 2.50 | 4.00 | 5.00 | 8.50 | 16.00 |
| Countersunk Bolt | n/a | 2.00 | 2.50 | 5.00 | 8.00 | n/a |

It can also be downloaded from www.pro-bolt.com in a separate document entitled 'Material Specification'.

For fasteners in general use, we recommend an anti-seize or a copper based lubricant be applied to the threads in order to prevent galling. If you are in any doubt as to the suitability or torque settings of our products for your specific application, please do not hesitate to contact us prior to fitment.



STAINLESS STEEL

AVAILABLE IN BLACK DLC, GOLD DLC & WITH A HIGH POLISH STAINLESS FINISH

Our stainless steel range of products is manufactured from 316 Stainless Steel, a premium quality product which offers superior strength and corrosion resistance.

Pro-Bolt stock high levels of tapered socket caps, flanged hex heads, race spec pre-drilled bolts, countersunk bolts and domed/mushroom fairing bolts. We offer a quality grade material in unique head styles. Our stainless range is available in a polished mirror finish, black and gold. Both black and gold have tough durable DLC coating.

- **Material specification:** 316 Stainless Steel.
- **Manufacturing process:** We manufacture in a single process on multi axis CNC machining centres, which includes thread rolling. Thread standards are to BS3692:1967 which is the British Standard for ISO Precision Metric Threads. Route radii vary between 0.8mm and 0.4mm. This is the maximum that we can use and improves shear strength. Thread lead varies between K1 and K2.
- **Material:** Stainless steels are iron alloys with a minimum of 16.5% Chromium with other elements (nickel, molybdenum, titanium, copper, carbon, Nitrogen) added to enhance properties such as formability and strength. It is the chromium-rich, oxide film that gives the corrosion resistance of stainless steel. This protective film is strong and chemically stable (i.e. passive) where there is sufficient oxygen on the surface. The protection is extremely thin and will usually self-repair if sufficient oxygen is available. Please note that under certain conditions the passive state can be broken down and corrosion can result.
- **Heat resistance:** 316 has good resistance to oxidation in continuous service to 870°C and intermittent service to 925°C. However, continuous use at 425-860°C is not recommended due to its resistance to carbide precipitation. Where high strength is required at temperatures above 500°C, Grade 316H is recommended.
- **Tribobond™ DLC** coatings increase component lifetime dramatically. The enhanced tribological properties of Tribobond™ coatings not only protect the components from wear but also polish and protect the counter parts during in-running. As a result, the tribo system will remain in a low friction and wear condition.

MATERIAL PROPERTIES

- Density:8030 kg/m³ (501lb/ft³)
- Young's Modulus:..... 193GPa (28 x 10⁶psi)
- Yield Strength:.....260MPa (37.7 x 10³psi)
- Ultimate Tensile Strength:570MPa (82.7 x 10³psi)
- Compressive Strength:260MPa (37.7 x 10³psi)
- Shear Modulus:78GPa (11.3 x 10⁶psi)
- Ductility:40% elongation at break +
- Minimum value allowed by ASTM A240
- Poisson's Ratio:0.27
- Hardness:95 Rockwell B +
- Maximum value allowed by ASTM A240
- Strength-to-Weight Ratio:32.4kNm/kg
- Stiffness-to-Weight Ratio:.....24 M Nm/kg

| Thread Diameter | Material Tensile Stress Area (mm²) | Max Load (kN) | Total Elongation (mm) |
|-----------------|------------------------------------|---------------|-----------------------|
| M6 | 20.1 | 16.40 | 1.93 |
| M8 | 36.6 | 29.15 | 2.85 |
| M10 | 58.0 | 46.89 | 3.70 |

TORQUE & LUBRICATION:

When individual bolts are purchased, torque guides vary depending on the material, manufacturing method, thread diameter, pitch and head style. *This torque information can be found below.*

| Maximum Torque Guide - Stainless Steel in Nm | | | | | | |
|--|------|------|-------|-------|-------|-------|
| Thread Diameter | M3 | M4 | M5 | M6 | M8 | M10 |
| Flanged Hex Head Bolt | 2.00 | 5.00 | 12.00 | 15.00 | 35.00 | 38.00 |
| Tapered Socket Cap | 1.73 | 4.00 | 10.00 | 14.00 | 25.00 | 38.00 |
| Dome Head Bolt | n/a | 3.50 | 5.00 | 11.00 | 16.00 | 26.00 |
| Countersunk Bolt | n/a | 3.50 | 5.00 | 8.00 | 15.00 | 20.00 |

It can also be downloaded from www.pro-bolt.com in a separate document entitled 'Material Specification'.



MATERIALS

TITANIUM

ALL AVAILABLE IN A CHOICE OF 5 COLOURS:
BLACK DLC • BLUE • GOLD • NATURAL • PURPLE HAZE

Made from aircraft grade Titanium 6AL-4V (grade 5), our titanium bolts have a tensile strength in excess of 120,000psi, suitable for replacing both grade 5 and grade 8 steel bolts. In addition, we roll the threads to produce greater fatigue strength and reduce galling.

New to our titanium range is our unique and innovative 'DualDrive' bolt, designed for race teams this ultimate bolt combines form and function and offers superb functionality, strength and durability. You can select the appropriate tool, depending on accessibility & torque required. Head design is compatible with both a socket and allen key, our forged DualDrive offers rolled threads for superior strength and are pre-drilled for lockwiring.

New across our entire titanium range is a stunning black finish which is a tough durable 'DLC' coating.

We offer tapered, socket cap, flanged hex head, drilled race spec, countersunk, and dome head bolts, nuts and washers – from 3mm to 12mm. We also offer axle nuts, swingarm nuts, yoke nuts, caliper pins, banjo bolts, disc bolts and many more specifically machined items. Our titanium range is available in natural, blue, black, gold and purple haze.

- **Material specification:** Ti-6Al-4V, an alloy introduced in 1954, is a good general purpose grade. Titanium alloy is available in all product forms. Its density is 0.160 pounds per cubic inch, it can be heat-treated to ultimate strengths in excess of 170,000psi and responds to heat treatment in sections up to 15mm. This alloy is stable at temperatures ranging from 423°F to over 1000°F.
- **Manufacturing process:** We manufacture in a single process on multi axis CNC machining centres, which includes thread rolling. Thread standards are to BS3692:1967 which is the British Standard for ISO Precision Metric Threads. Route radii vary between 0.8mm and 0.4mm. This is the maximum that we can use and improves shear strength. Thread lead varies between K1 and K2.
- **Weight:** 42% lighter than steel.
- **Other items:** Machined from bar.
- **Tribobond™ DLC** coatings increase component lifetime dramatically. The enhanced tribological properties of Tribobond™ coatings not only protect the components from wear but also polish and protect the counter parts during in-running. As a result, the tribo system will remain in a low friction and wear condition.

MATERIAL PROPERTIES

- Density:4420 kg/m³ (276lb/ft³)
- Young's Modulus:..... 110GPa (16 x 10⁶psi)
- Yield Strength:828 MPa (120 x 10³psi)
- Ultimate Tensile Strength:..... 1030MPa (149 x 10³psi)

- Compressive Strength:960MPa (139 x 10³psi)
- Shear Modulus: 43GPa (6.24 x 10⁶psi)
- Ductility:10% elongation at break
- Poisson's Ratio:0.34
- Hardness:36 Rockwell C
- Maximum value allowed by ASTM A240
- Strength-to-Weight Ratio..... 187kNm/kg
- Stiffness-to-Weight Ratio..... 24.9MNm/kg

| Thread Diameter | Material Tensile Stress Area (mm ²) | Max Load (kN) | Total Elongation (mm) |
|-----------------|---|---------------|-----------------------|
| M6 | 20.1 | 21.25 | 0.54 |
| M8 | 36.6 | 36.78 | 0.48 |
| M10 | 58.0 | 53.53 | 1.45 |

TORQUE & LUBRICATION

When individual bolts are purchased, torque guides vary depending on the material, manufacturing method, thread diameter, pitch and head style. *This torque information can be found below.*

| Thread Diameter | Maximum Torque Guide - Titanium Nm | | | | | | |
|-----------------------|------------------------------------|------|-------|-------|-------|-------|-------|
| | M3 | M4 | M5 | M6 | M8 | M10 | M12 |
| Flanged Hex Head Bolt | 2.00 | 5.00 | 12.00 | 15.00 | 35.00 | 38.00 | 97.50 |
| Dual Drive | n/a | n/a | 9.00 | 15.00 | 45.00 | 50.00 | n/a |
| Tapered Socket Cap | 1.73 | 4.00 | 10.00 | 14.00 | 25.00 | 38.00 | n/a |
| Dome Head Bolt | n/a | 3.50 | 5.00 | 11.00 | 16.00 | 26.00 | n/a |
| Countersunk Bolt | n/a | 3.50 | 5.00 | 8.00 | 15.00 | 20.00 | n/a |

It can also be downloaded from www.pro-bolt.com in a separate document entitled 'Material Specification'.

For fasteners in general use, we recommend an anti-seize or a copper based lubricant be applied to the threads in order to prevent galling, the exception being bleed nipples and banjo bolts which should be fitted dry. For bolts in safety critical areas, we would recommend a medium strength threadlock. If you are in any doubt as to the suitability or torque settings of our products for your specific application, please do not hesitate to contact us prior to fitment.

Torque guide for fasteners in general usage

Torque for flanged hex head and tapered socket cap bolts - use torque values specified by your equipment manufacturer. Where possible use the same torque as manufacturer's originals. For fasteners in safety applications on a motorcycle, use your manufacturers torque guide when fitting flanged hex head or tapered socket cap fasteners. For fasteners in other applications you can refer to the table above for lubricated threads.



Flanged Hex Head Bolts (Available in Stainless Steel | Titanium)

Please Note: Not all combinations of thread length, thread diameter, and thread pitch are available in every material

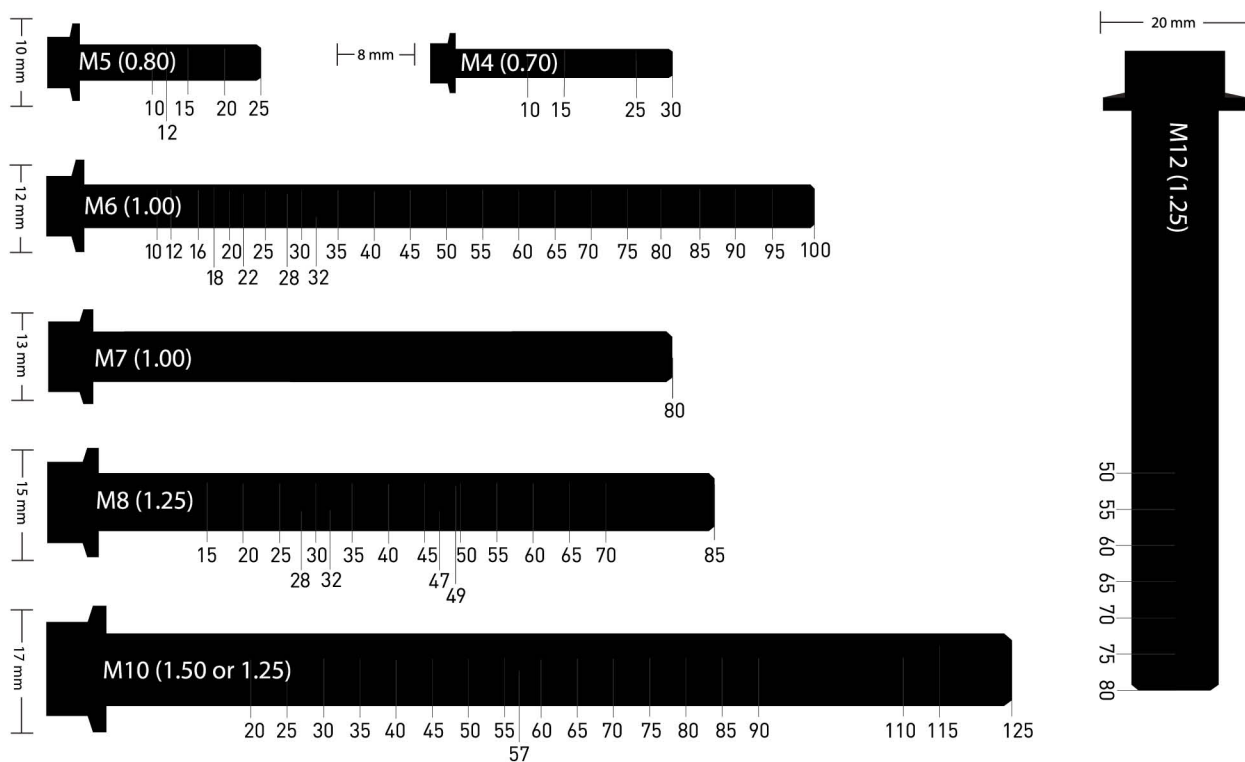

Dual Drive Bolts (Available in Titanium)

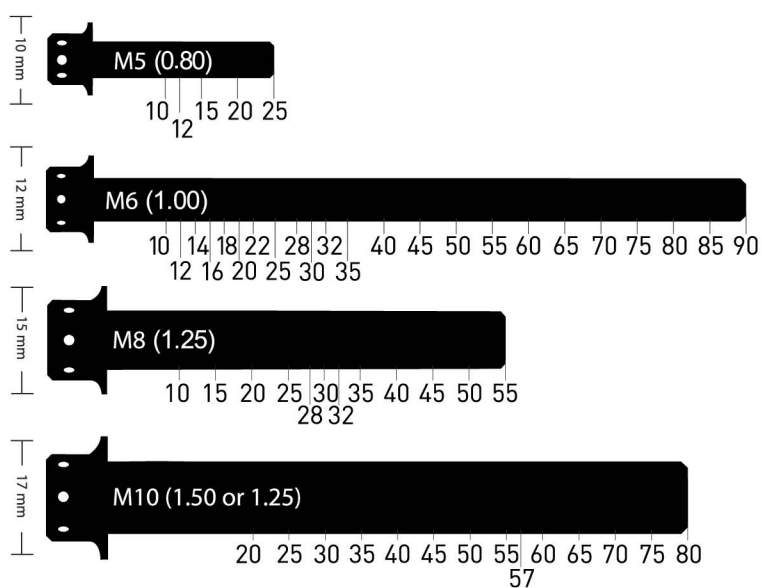

PRODUCT SILHOUETTES

Race Spec Bolts (Available in Aluminium | Stainless Steel | Titanium)

Please Note: Not all combinations of thread length, thread diameter, and thread pitch are available in every material

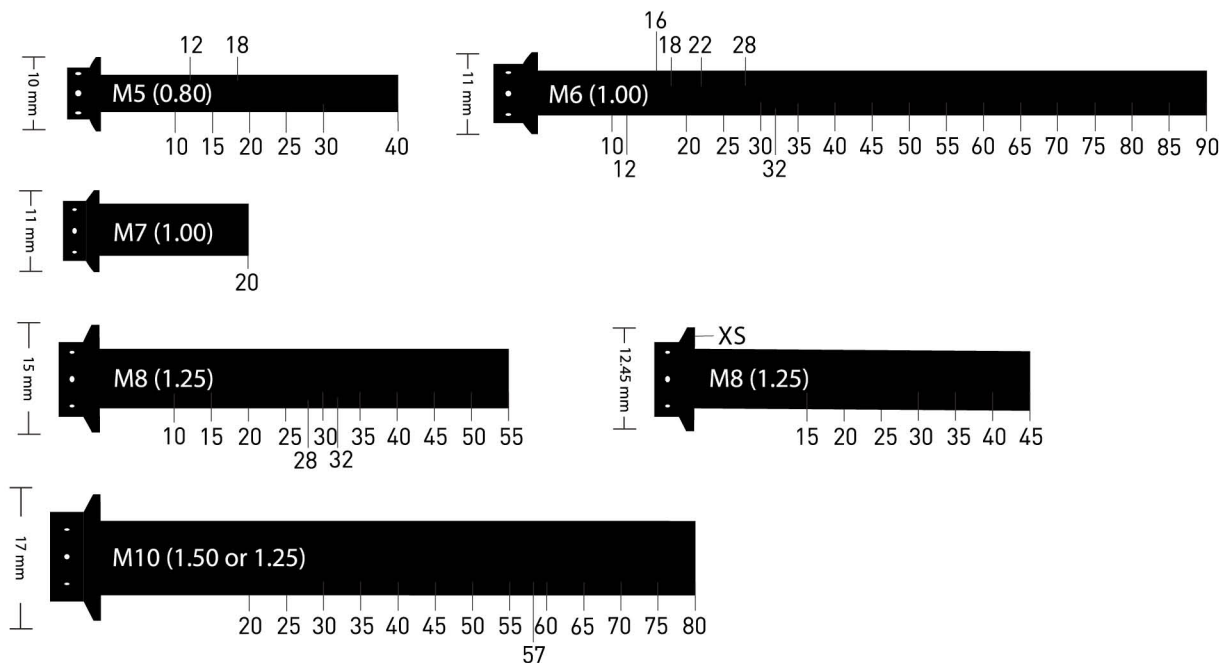

Race Spec Bodywork Bolts (Available in Aluminium)

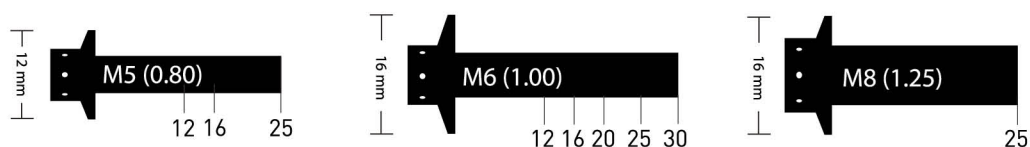

Self Tapping Screw (Available in Aluminium)

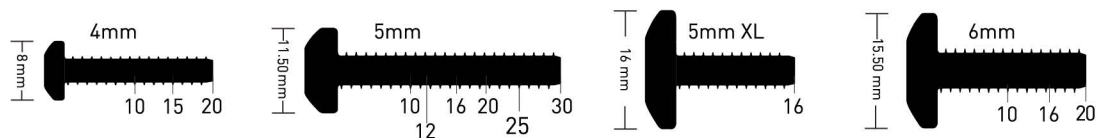

Cylindrical Head Torx Drive (Available in Titanium)

Please Note: Not all combinations of thread length, thread diameter, and thread pitch are available in every material

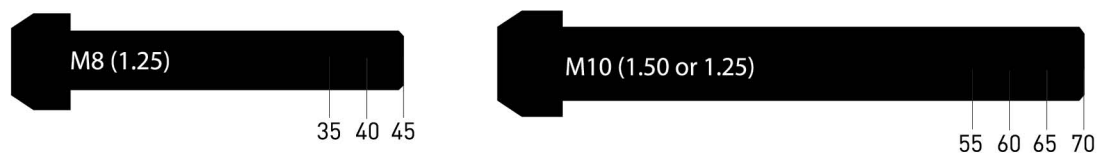

Allen Key Socket Cap Bolts (Available in Aluminium | Stainless Steel | Titanium)

Please Note: Not all combinations of thread length, thread diameter, and thread pitch are available in every material

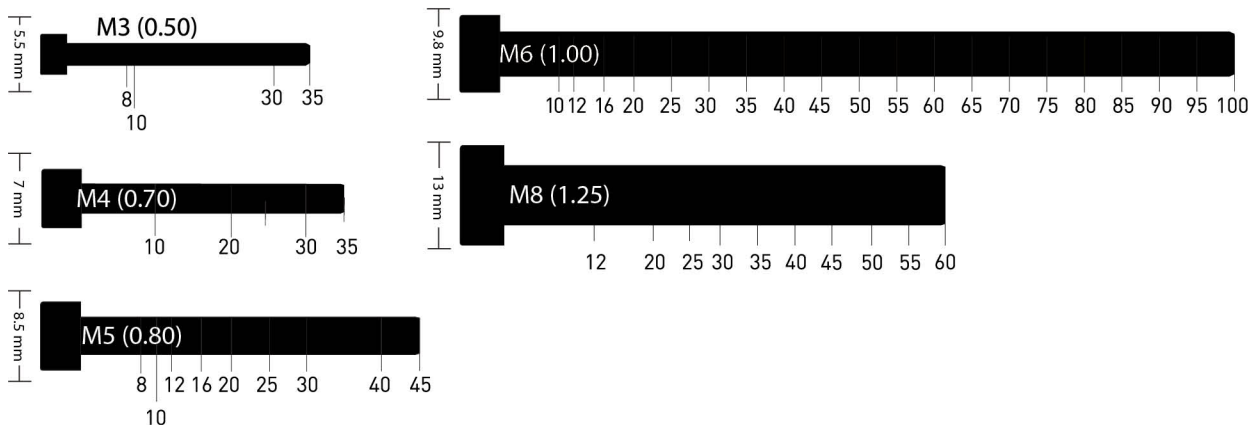

Countersunk Bolts (Available in Aluminium | Stainless Steel | Titanium)

Please Note: Not all combinations of thread length, thread diameter, and thread pitch are available in every material

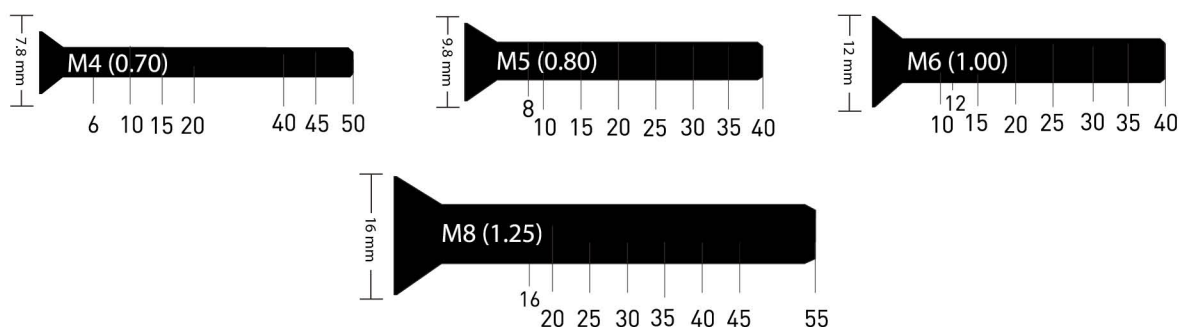

Dome Head/Fairing Bolts (Available in Aluminium | Stainless Steel | Titanium)

Please Note: Not all combinations of thread length, thread diameter, and thread pitch are available in every material

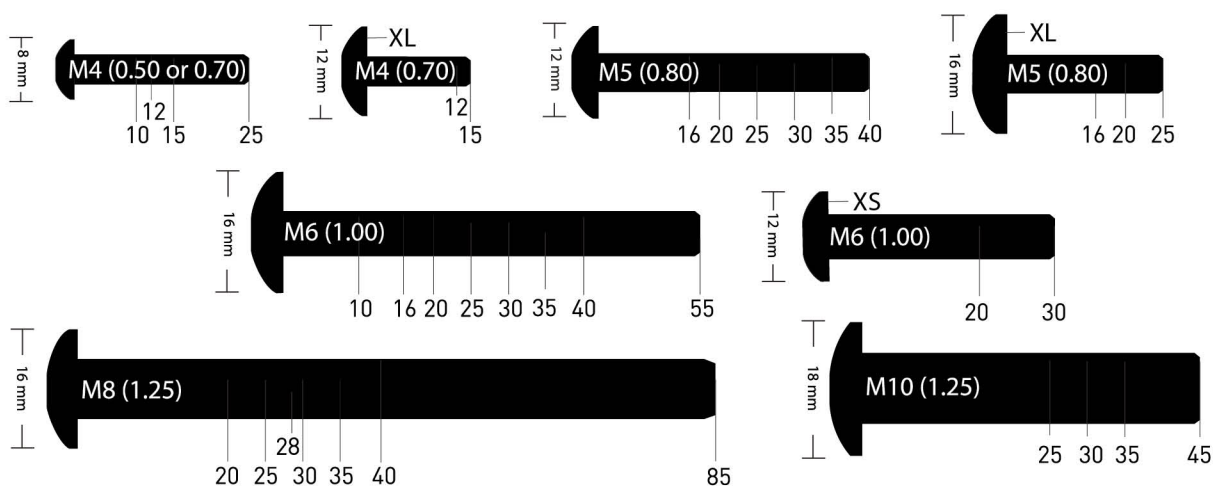

PRODUCT SILHOUETTES

Tapered Socket Cap Bolts (Available in Stainless Steel | Titanium)

Please Note: Not all combinations of thread length, thread diameter, and thread pitch are available in every material

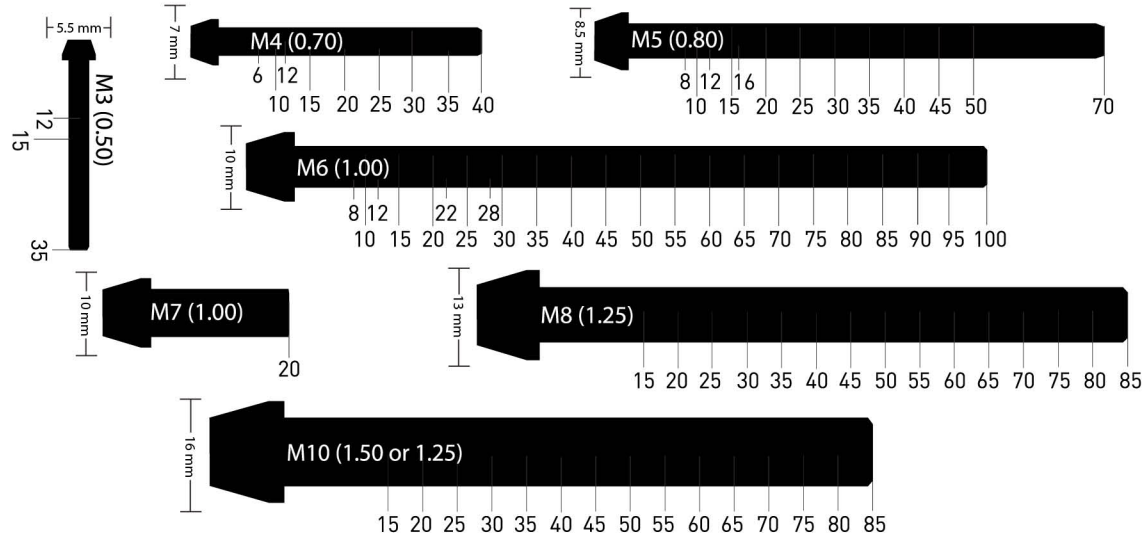

Countersunk Bodywork Washers (Available in Aluminium | Stainless Steel | Titanium)

Please Note: Not all combinations of thread length, thread diameter, and thread pitch are available in every material



Flat Washers (Available in Aluminium | Stainless Steel | Titanium)

Please Note: Not all combinations of thread length, thread diameter, and thread pitch are available in every material

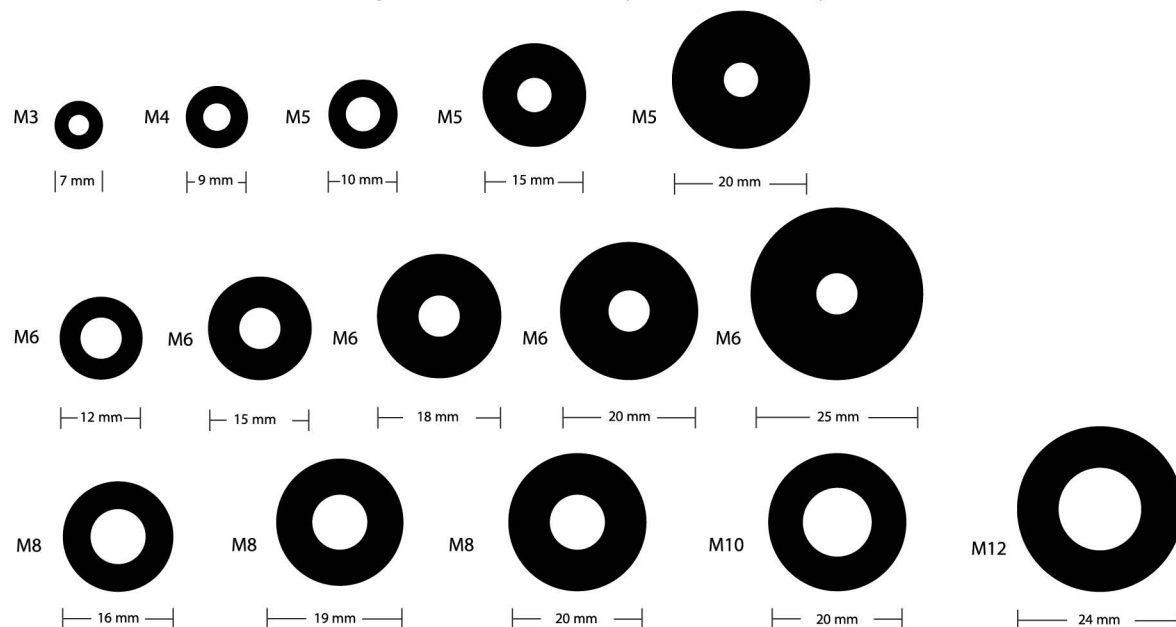

Drilled Washers (Available in Aluminium | Titanium)

Please Note: Not all combinations of thread length, thread diameter, and thread pitch are available in every material

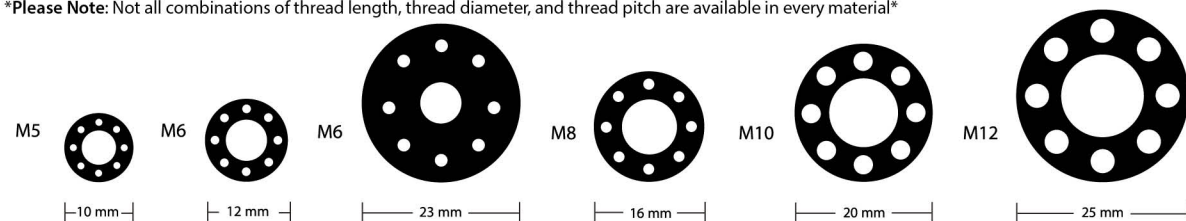

ALUMINIUM BOLTS

ALL AVAILABLE IN A CHOICE OF 7 COLOURS:
BLACK • BLUE • GOLD • ORANGE • PURPLE • RED • SILVER

Standard Allen Key Socket Cap Bolts

| Part Number | Thread & Pitch | Head Diameter | Allen Key Size | Lengths Available |
|-------------|----------------|---------------|----------------|---|
| LPB3** | M3 x (0.50mm) | 5.50mm | 2.5mm | 8mm, 10mm, 30mm, 35mm |
| LPB4** | M4 x (0.70mm) | 7mm | 3mm | 10mm, 20mm, 25mm, 30mm, 35mm |
| LPB5** | M5 x (0.80mm) | 8.50mm | 4mm | 8mm, 10mm, 12mm, 16mm, 20mm, 25mm, 30mm, 40mm, 45mm |
| LPB6** | M6 x (1.00mm) | 10mm | 5mm | 10mm, 12mm, 16mm, 20mm, 25mm, 30mm, 35mm, 40mm, 45mm, 50mm, 55mm, 60mm, 65mm, 70mm, 75mm, 80mm, 90mm, 95mm, 100mm |
| LPB8** | M8 x (1.25mm) | 13mm | 6mm | 12mm, 20mm, 25mm, 30mm, 35mm, 40mm, 60mm |

Dome Head/Fairing Bolts

| Part Number | Thread & Pitch | Head Diameter | Allen Key Size | Length Available |
|-------------|----------------|---------------|----------------|--|
| LFB412F | M4 x (0.50mm) | 8mm | 2.5mm | 12mm |
| LFB4** | M4 x (0.70mm) | 8mm | 2.5mm | 12mm, 25mm |
| LFB4**XL | M4 x (0.70mm) | 12mm | 2.5mm | 12mm, 15mm |
| LFB5** | M5 x (0.80mm) | 12mm | 3mm | 12mm, 16mm, 20mm, 25mm, 35mm, 40mm |
| LFB5**XL | M5 x (0.80mm) | 16mm | 3mm | 16mm, 20mm, 25mm, 30mm |
| LFB6** | M6 x (1.00mm) | 16mm | 4mm | 10mm, 16mm, 20mm, 25mm, 30mm, 35mm, 40mm |
| LFB6**XS | M6 x (1.00mm) | 12mm | 4mm | 20mm, 30mm |
| LFB8** | M8 x (1.25mm) | 16mm | 4mm | 25mm, 40mm |
| LFB10**F | M10 x (1.25mm) | 17.50mm | 6mm | 25mm, 45mm |

Countersunk Bolts

(Length measured includes the head)

| Part Number | Thread & Pitch | Allen Key Size | Lengths Available |
|-------------|----------------|----------------|------------------------------|
| LCS4** | M4 x (0.70mm) | 2.50mm | 15mm, 20mm, 45mm, 50mm, 66mm |
| LCS5** | M5 x (0.80mm) | 3mm | 20mm, 30mm, 35mm |
| LCS6** | M6 x (1.00mm) | 4mm | 15mm, 20mm, 25mm, 35mm |
| LCS8** | M8 x (1.25mm) | 6mm | 20mm, 40mm |

Self Tapping Screw

| Part Number | Thread Diameter | Head Diameter | Allen Key size | Length Available |
|-------------|-----------------|---------------|----------------|------------------------------------|
| LSTB4** | 4mm | 8mm | 3mm | 10mm, 15mm, 20mm |
| LSTB5** | 5mm | 11.50mm | 4mm | 10mm, 12mm, 16mm, 20mm, 25mm, 30mm |
| LSTB516XL | 5mm | 16mm | 4mm | 16mm |
| LSTB6** | 6mm | 15.50mm | 5mm | 10mm, 16mm, 20mm |

Honda Special Fuel Cap Bolts

| Part Number | Thread & Pitch | Head Diameter | Lengths Available |
|-------------|----------------|---------------|-------------------|
| LH4** | (M4 x 0.70mm) | 10mm | 6.5mm, 20mm |

**All length measurements, apart from countersunk bolts, are taken from below the head



PRO-BOLT RANGE - ALUMINIUM

ALUMINIUM BOLTS

ALL AVAILABLE IN A CHOICE OF 7 COLOURS:
BLACK • BLUE • GOLD • ORANGE • PURPLE • RED • SILVER

Race Spec Hex Head Bolts

Machined with Rolled Threads for superior strength. Widely used by racers, enthusiasts and those who like attention to detail. The heads are pre-drilled on the flats for ease of lockwiring and etched with the Pro-Bolt name. Outstanding 62% weight saving over equivalent sized steel bolts.

| Part Number | Thread/Pitch | Socket Size | Flange Diameter | Lengths Available |
|-------------|----------------|-------------|-----------------|--|
| LHX5**RE | M5 x (0.80mm) | 7mm | 10mm | 10mm, 12mm, 16mm, 20mm, 25mm, 30mm, 35mm |
| LHX6**RE | M6 x (1.00mm) | 8mm | 12mm | 10mm, 12mm, 15mm, 20mm, 25mm, 30mm, 35mm, 40mm, 45mm, 50mm, 55mm, 60mm, 65mm, 70mm, 75mm, 80mm, 85mm |
| LHX8**RE | M8 x (1.25mm) | 10mm | 15mm | 10mm, 15mm, 20mm, 25mm, 30mm, 35mm, 40mm, 45mm |
| LHX10**FRE | M10 x (1.25mm) | 12mm | 17mm | 25mm, 30mm, 35mm, 40mm, 45mm, 50mm, 55mm, 60mm, 65mm, 70mm, 75mm |



Race Spec Body Bolts

Our Bodywork Bolt Range in 7075 Aluminium are machined with Rolled Threads for superior strength. Perfect for plastics/bodywork where the large diameter will prevent bolts 'pulling through' bodywork. The external hex drive on the head offers enhanced strength. The heads are pre-drilled on the flats for ease of lockwiring. Outstanding 62% weight saving over equivalent sized steel bolts.

| Part Number | Thread/Pitch | Socket Size | Flange Diameter | Lengths Available |
|-------------|---------------|-------------|-----------------|------------------------------|
| LBWHX5**RE | M5 x (0.80mm) | 7mm | 12mm | 12mm, 16mm, 25mm |
| LBWHX6**RE | M6 x (1.00mm) | 8mm | 16mm | 12mm, 16mm, 20mm, 25mm, 30mm |
| LBWHX8**RE | M8 x (1.25mm) | 10mm | 16mm | 25mm |





PRO-BOLT RANGE - ALUMINIUM

ALUMINIUM

ALL AVAILABLE IN A CHOICE OF 7 COLOURS:
BLACK • BLUE • GOLD • ORANGE • PURPLE • RED • SILVER

These quick release fasteners makes removal of bodywork easy and fast. Supplied individually or in packs. Available packs and lengths are listed below – choose from D-Ring, Scalloped Head or Allen Key Drive, all with a superb finish. Now supplied with springs to ensure a tight fit for race frings.

Quick Release D-Ring

| Part Number | Description |
|-------------|---|
| QRCLIP17 | 17mm Individual D-Ring Quick Release Fastener |
| QRCLIP19 | 19mm Individual D-Ring Quick Release Fastener |



Quick Release Allen Key Drive

| Part Number | Description |
|-------------|--|
| QRCLIPAK17 | 17mm Individual Allen Key Quick Release Fastener |
| QRCLIPAK19 | 19mm Individual Allen Key Quick Release Fastener |



PRO-BOLT RANGE - ALUMINIUM

ALUMINIUM NUTS

ALL AVAILABLE IN A CHOICE OF 7 COLOURS:
BLACK • BLUE • GOLD • ORANGE • PURPLE • RED • SILVER

Full Nuts

| Part Number | Thread & Pitch | Socket Size | Height |
|---------------------------|----------------|-------------|--------|
| LFN4 | M4 x (0.70mm) | 7mm | 5mm |
| LFN5 | M5 x (0.80mm) | 8mm | 3.80mm |
| LFN6 | M6 x (1.00mm) | 10mm | 4.70mm |
| LFN6LH (Left Hand Thread) | M6 x (1.00mm) | 10mm | 4.70mm |
| LFN8 | M8 x (1.25mm) | 13mm | 6.30mm |

Nyloc Nuts

| Part Number | Thread & Pitch | Socket Size | Height |
|-------------|----------------|-------------|--------|
| LNYN3 | M3 x (0.70mm) | 5.5mm | 3.92mm |
| LNYN4 | M4 x (0.70mm) | 7mm | 5mm |
| LNYN5 | M5 x (0.80mm) | 8mm | 5mm |
| LNYN6 | M6 x (1.00mm) | 10mm | 5.80mm |
| LNYN8 | M8 x (1.25mm) | 13mm | 8mm |
| LNYN10 | M10 x (1.50mm) | 17mm | 10mm |
| LNYN10F | M10 x (1.25mm) | 13mm | 10mm |

Dome Nuts

| Part Number | Thread & Pitch | Socket Size | Height |
|-------------|----------------|-------------|--------|
| LDOMENUT4 | M4 x (0.70mm) | 7mm | 8mm |
| LDOMENUT5 | M5 x (0.80mm) | 8mm | 10mm |
| LDOMENUT6 | M6 x (1.00mm) | 10mm | 12mm |
| LDOMENUT8 | M8 x (1.25mm) | 13mm | 15mm |
| LDOMENUT10F | M10 x (1.25mm) | 17mm | 18mm |
| LDOMENUT10 | M10 x (1.50mm) | 17mm | 18mm |



ALUMINIUM WASHERS

ALL AVAILABLE IN A CHOICE OF 7 COLOURS:
BLACK • BLUE • GOLD • ORANGE • PURPLE • RED • SILVER

Flat Washers

| Part Number | Inside Diameter | Outside Diameter | Thickness |
|-------------|-----------------|------------------|-----------|
| LWA3 | M3 | 7mm | 0.55mm |
| LWA4 | M4 | 9mm | 0.80mm |
| LWA5 | M5 | 10mm | 0.90mm |
| LWA6 | M6 | 12mm | 1.40mm |
| LWA6-18 | M6 | 18mm | 1.40mm |
| LWA8 | M8 | 16mm | 1.50mm |
| LWA8-20 | M8 | 20mm | 1.60mm |
| LWA10 | M10 | 20mm | 1.77mm |

Drilled Washers

| Part Number | Inside Diameter | Outside Diameter | Thickness |
|-------------|-----------------|------------------|-----------|
| LWAD5 | M5 | 10mm | 1.30mm |
| LWAD6 | M6 | 12mm | 1.50mm |
| LWAD6-23 | M6 | 23mm | 1.50mm |
| LWAD8 | M8 | 16mm | 1.90mm |
| LWAD10 | M10 | 20mm | 2.80mm |
| LWAD12 | M12 | 25mm | 3.40mm |

Countersunk Bodywork Washers

| Part Number | Inside Diameter | Outside Diameter | Thickness |
|-------------|-----------------|------------------|-----------|
| LWAC5 | M5 | 13mm | 3.20mm |
| LWAC6-19 | M6 | 19mm | 3.40mm |
| LWAC6-22 | M6 | 22mm | 3.40mm |
| LWAC8 | M8 | 25mm | 5.00mm |

Flared Washers

Manufactured to be fitted with a standard socket cap bolt

| Part Number | Inside Diameter | Outside Diameter | Thickness |
|-------------|-----------------|------------------|-----------|
| LWAPB625 | M6 | 25mm | 10mm |



STAINLESS STEEL BOLTS

AVAILABLE IN BLACK, GOLD OR WITH
A HIGH POLISH STAINLESS FINISH

Tapered Socket Cap

| Part Number | Thread Diameter/Pitch | Allen Key Drive | Max Head Diameter | Lengths Available |
|-------------|-----------------------|-----------------|-------------------|--|
| LSSSC5** | M5 x (0.80mm) | 4mm | 8mm | 10mm, 12mm, 15mm, 20mm, 25mm, 30mm |
| LSSSC6** | M6 x (1.00mm) | 5mm | 10mm | 10mm, 12mm, 15mm, 20mm, 25mm, 30mm, 35mm, 40mm, 45mm, 50mm, 55mm, 60mm, 65mm, 70mm, 75mm, 80mm, 85mm, 90mm, 95mm |
| LSSSC8** | M8 x (1.25mm) | 6mm | 12.50mm | 15mm, 20mm, 25mm, 30mm, 35mm, 40mm, 45mm, 50mm, 55mm, 60mm, 65mm, 70mm, 75mm, |
| LSSSC10** | M10 x (1.50mm) | 8mm | 16mm | 20mm, 25mm |
| LSSSC10**F | M10 x (1.25mm) | 8mm | 16mm | 20mm, 25mm, 30mm, 35mm, 40mm, 45mm, 50mm, 55mm, 60mm, 65mm, 70mm, 75mm, 80mm, 85mm |

Flanged Hex Head

| Part Number | Thread Diameter/Pitch | Socket Size | Max Head Diameter | Lengths Available |
|-------------|-----------------------|-------------|-------------------|--|
| LSSHX5** | M5 x (0.80mm) | 7mm | 10mm | 10mm, 12mm, 16mm, 20mm, 25mm, 30mm, 35mm |
| LSSHX6** | M6 x (1.00mm) | 8mm | 12mm | 10mm, 12mm, 15mm, 20mm, 25mm, 27mm, 30mm, 35mm, 40mm, 45mm, 50mm, 55mm, 60mm, 65mm, 70mm, 75mm, 80mm, 85mm, 90mm |
| LSSHX8** | M8 x (1.25mm) | 12mm | 16mm | 15mm, 20mm, 25mm, 28mm, 30mm, 32mm, 35mm, 40mm, 45mm, 50mm, 55mm, 60mm, 65mm, 70mm, 75mm |
| LSSHX10** F | M10 x (1.25mm) | 12mm | 18mm | 20mm, 25mm, 30mm, 35mm, 40mm, 45mm, 50mm, 55mm, 57mm, 60mm, 65mm, 70mm, 75mm, 80mm |
| LSSHX10** | M10 x (1.50mm) | 12mm | 17mm | 60mm, 65mm |

Race Spec Flanged Hex Head Bolts

| Part Number | Thread Diameter/Pitch | Socket Size | Max Head Diameter | Lengths Available |
|-------------|-----------------------|-------------|-------------------|--|
| LSSHX5**R | M5 x (0.80mm) | 7mm | 10mm | 10mm |
| LSSHX6**R | M6 x (1.00mm) | 8mm | 12mm | 10mm, 12mm, 15mm, 20mm, 25mm, 30mm, 35mm, 40mm, 45mm, 50mm, 55mm, 60mm, 65mm, 70mm, 75mm, 80mm, 85mm, 90mm |
| LSSHX8**R | M8 x (1.25mm) | 12mm | 16mm | 25mm, 30mm, 35mm, 40mm, 45mm |
| LSSHX10**FR | M10 x (1.25mm) | 12mm | 17mm | 25mm, 30mm, 35mm, 60mm, 65mm, 70mm, 75mm |
| LSSHX10**R | M10 x (1.50mm) | 12mm | 17mm | 25mm, 65mm, |

Countersunk Bolts

(Length measured includes the head)

| Part Number | Thread Diameter/Pitch | Allen Key Drive | Max Head Diameter | Lengths Available |
|-------------|-----------------------|-----------------|-------------------|------------------------------------|
| LSSCS5** | M5 x (0.80mm) | 3mm | 10mm | 15mm, 20mm, 25mm, 30mm, 35mm |
| LSSCS6** | M6 x (1.00mm) | 4mm | 12mm | 15mm, 20mm, 25mm, 30mm, 35mm, 40mm |
| LSSCS8** | M8 x (1.25mm) | 5mm | 15.70mm | 30mm, 40mm |
| LSSCS1265F | M12 x (1.50mm) | 8mm | 24.00mm | 65mm |



PRO-BOLT RANGE - STAINLESS STEEL

STAINLESS STEEL

AVAILABLE IN BLACK, GOLD OR WITH
A HIGH POLISH STAINLESS FINISH

Parallel Head Bolts

| Part Number | Thread Diameter/Pitch | Allen key size | Max Head Diameter | Lengths Available |
|-------------|-----------------------|----------------|-------------------|---|
| LSSPB5** | M5 x (0.80mm) | 4mm | 8mm | 8mm, 10mm, 12mm, 16mm, 20mm, 25mm, 30mm |
| LSSPB6** | M6 x (1.00mm) | 5mm | 10mm | 10mm, 12mm, 16mm, 20mm, 25mm, 30mm |
| LSSPB8** | M8 x (1.25mm) | 6mm | 12.50mm | 40mm, 45mm, 50mm, 55mm, 60mm |
| LSSPB1060F | M10 x (1.25mm) | 8mm | 15mm | 60mm |

All length measurements are taken from below the head

Dome Head/Fairing Bolts

| Part Number | Thread Diameter/Pitch | Allen key size | Max Head Diameter | Lengths Available |
|----------------|-----------------------|----------------|-------------------|--|
| LSSFB412F | M4 x (0.50) | 2.50mm | 8mm | 12mm |
| LSSFB412 | M4 x (0.70) | 2.50mm | 8mm | 12mm |
| LSSFB516XS | M5 x (0.80) | 3mm | 9mm | 16mm |
| LSSFB5** | M5 x (0.80) | 4mm | 12mm | 12mm, 16mm, 20mm, 25mm, 30mm, 35mm |
| LSSFB5**XL | M5 x (0.80) | 4mm | 16mm | 16mm, 20mm, 25mm |
| LSSFB5**XL-AK3 | M5 x (0.80) | 3mm | 16mm | 16mm, 20mm, 25mm |
| LSSFB6** | M6 x (1.00) | 5mm | 16mm | 10mm, 16mm, 20mm, 25mm, 30mm, 35mm, 40mm |
| LSSFB6**XS | M6 x (1.00) | 5mm | 12mm | 16mm, 20mm, 30mm |
| LSSFB8** | M8 x (1.25) | 5mm | 16mm | 20mm, 25mm, 30mm, 40mm, 45mm |
| LSSFB10**F | M10 x (1.25) | 6mm | 18mm | 25mm, 30mm, 35mm |

Quick Release D-Ring

| Part Number | Description |
|-------------|------------------------------------|
| LSSQRCLIP14 | 14mm D-Ring Quick Release Fastener |
| LSSQRCLIP17 | 17mm D-Ring Quick Release Fastener |
| LSSQRCLIP19 | 19mm D-Ring Quick Release Fastener |

Quick Release Allen Key Drive

| Part Number | Description |
|---------------|---------------------------------------|
| LSSQRCLIPAK14 | 14mm Allen Key Quick Release Fastener |
| LSSQRCLIPAK17 | 17mm Allen Key Quick Release Fastener |
| LSSQRCLIPAK19 | 19mm Allen Key Quick Release Fastener |



STAINLESS STEEL NUTS

AVAILABLE IN BLACK, GOLD OR WITH A HIGH POLISH STAINLESS FINISH

Flanged Nuts

| Part Number | Thread Diameter/Pitch | Socket Size |
|-------------|-----------------------|-------------|
| LSSFLN5 | M5 x (0.80mm) | 8mm |
| LSSFLN6 | M6 x (1.00mm) | 10mm |
| LSSFLN8 | M8 x (1.25mm) | 12mm |
| LSSFLN10 | M10 x (1.50mm) | 14mm |
| LSSFLN10F | M10 x (1.25mm) | 14mm |
| LSSFLN10FF | M10 x (1.00mm) | 14mm |
| LSSFLN12F | M12 x (1.50mm) | 15mm |
| LSSFLN12FF | M12 x (1.25mm) | 15mm |

Dome Nuts

| Part Number | Thread Diameter/Pitch | Socket Size |
|---------------|-----------------------|-------------|
| LSSDOMENUT6 | M6 x (1.00mm) | 10mm |
| LSSDOMENUT8 | M8 x (1.25mm) | 13mm |
| LSSDOMENUT10F | M10 x (1.25mm) | 17mm |



STAINLESS STEEL NUTS

AVAILABLE IN NATURAL ONLY WITH A HIGH POLISH STAINLESS FINISH

Nyloc Nuts

| Part Number | Thread Diameter/Pitch | Socket Size |
|-------------|-----------------------|-------------|
| LSSNYN5 | M5 x (0.80mm) | 8mm |
| LSSNYN6 | M6 x (1.00mm) | 10mm |
| LSSNYN8 | M8 x (1.25mm) | 13mm |
| LSSNYN10 | M10 x (1.50mm) | 17mm |
| LSSNYN10F | M10 x (1.25mm) | 17mm |



STAINLESS STEEL WASHERS

AVAILABLE IN BLACK, GOLD OR WITH A HIGH POLISH STAINLESS FINISH

Flat Washers

| Part Number | Inside Diameter | Outside Diameter | Thickness |
|-------------|-----------------|------------------|-----------|
| LSSWA6 | 6mm | 12mm | 1.50mm |
| LSSWA6-15 | 6mm | 15mm | 2mm |
| LSSWA8 | 8mm | 16mm | 2mm |
| LSSWA10 | 10mm | 20mm | 2mm |

Countersunk Washers

| Part Number | Size | Outside Diameter | Thickness |
|-------------|------|------------------|-----------|
| LSSWAC5-15 | M5 | 15mm | 4mm |
| LSSWAC6-19 | M6 | 19mm | 4.50mm |
| LSSWAC6-22 | M6 | 22mm | 4.50mm |
| LSSWAC8-25 | M8 | 25mm | 5.50mm |



PRO-BOLT RANGE - TITANIUM

TITANIUM BOLTS

ALL AVAILABLE IN A CHOICE OF 5 COLOURS:
BLACK • BLUE • GOLD • NATURAL • PURPLE HAZE

Dome Head/Fairing Bolts

Length measurements are taken from **below** the head

| Part Number | Thread Diameter/Pitch | Allen Key Drive | Max Head Diameter | Lengths Available |
|-------------|-----------------------|-----------------|-------------------|--|
| TIFB412F | M4 x (0.50mm) | 2.5mm | 8mm | 12mm |
| TIFB4** | M4 x (0.70mm) | 2.5mm | 8mm | 10mm, 12mm, 15mm |
| TIFB5**XS | M5 x (0.80mm) | 3mm | 9mm | 16mm |
| TIFB5**XSFH | M5 x (0.80mm) | 3mm | 9mm | 16mm |
| TIFB5** | M5 x (0.80mm) | 3mm | 12mm | 10mm, 12mm, 16mm, 20mm, 25mm, 30mm, 35mm |
| TIFB5**XL | M5 x (0.80mm) | 4mm | 16mm | 16mm, 25mm |
| TIFB6* | M6 x (1.00mm) | 5mm | 16mm | 10mm, 16mm, 20mm, 25mm, 30mm, 35mm, 40mm, 55mm |
| TIFB6**XS | M6 x (1.00mm) | 5mm | 12mm | 16mm, 20mm, 30mm |
| TIFB8** | M8 x (1.25mm) | 5mm | 16mm | 20mm, 25mm, 30mm, 35mm, 40mm, 85mm |

Countersunk Bolts

Length measurements **include** the head

| Part Number | Thread Diameter/Pitch | Allen Key Drive | Max Head Diameter | Lengths Available |
|-------------|-----------------------|-----------------|-------------------|--|
| TICS4** | M4 x (0.70mm) | 2.5mm | 8mm | 8mm, 10mm, 15mm, 20mm |
| TICS5** | M5 x (0.80mm) | 3mm | 10mm | 8mm, 10mm, 15mm, 20mm, 25mm, 30mm, 35mm |
| TICS6** | M6 x (1.00mm) | 4mm | 12mm | 10mm, 12mm, 15mm, 20mm, 25mm, 30mm, 35mm |
| TICS8** | M8 x (1.25mm) | 5mm | 16mm | 16mm, 20mm, 25mm, 30mm, 35mm, 40mm, 45mm, 55mm |

Tapered Socket Cap

| Part Number | Thread Diameter/Pitch | Allen Key Drive | Max Head Diameter | Lengths Available |
|-------------|-----------------------|-----------------|-------------------|--|
| TISC3** | M3 x (0.50mm) | 2.50mm | 5.5mm | 10mm, 12mm, 15mm, 35mm |
| TISC4** | M4 x (0.70mm) | 3mm | 7mm | 6mm, 10mm, 12mm, 15mm, 20mm, 25mm, 30mm, 35mm |
| TISC5** | M5 x (0.80mm) | 4mm | 8mm | 8mm, 10mm, 12mm, 16mm, 20mm, 25mm, 30mm, 35mm, 40mm, 45mm, 50mm, 55mm, 70mm |
| TISC6** | M6 x (1.00mm) | 5mm | 10mm | 8mm, 10mm, 12mm, 15mm, 20mm, 22mm, 25mm, 28mm, 30mm, 35mm, 40mm, 45mm, 50mm, 55mm, 60mm, 65mm, 70mm, 75mm, 80mm, 85mm, 90mm, 95mm, 100mm |
| TISC720 | M7 x (1.00mm) | 5mm | 10mm | 20mm |
| TISC8** | M8 x (1.25mm) | 6mm | 12.50mm | 15mm, 20mm, 25mm, 30mm, 35mm, 40mm, 45mm, 50mm, 55mm, 60mm, 65mm, 70mm, 80mm, 85mm |
| TISC10** | M10 x (1.50mm) | 8mm | 16mm | 20mm, 25mm, 30mm, 35mm, 40mm, 45mm, 50mm, 55mm, 65mm, 70mm, 80mm |
| TISC10**F | M10 x (1.25mm) | 8mm | 16mm | 20mm, 25mm, 30mm, 35mm, 40mm, 45mm, 50mm, 55mm, 60mm, 65mm, 70mm, 75mm, 80mm, 85mm |

Cylindrical Head Torx Drive

| Part Number | Thread Diameter/Pitch | Torx Drive | Max Head Diameter | Lengths Available |
|-------------|-----------------------|------------|-------------------|------------------------|
| TISCTX8** | M8 x (1.25mm) | T45 | 13mm | 35mm, 40mm, 45mm |
| TISCTX10** | M10 x (1.50mm) | T50 | | 65mm |
| TISCTX10**F | M10 x (1.25mm) | T50 | | 55mm, 60mm, 65mm, 70mm |

** Denotes length to be selected
All length measurements are taken from below the head (For every bolts but countersunk)



TITANIUM BOLTS

ALL AVAILABLE IN A CHOICE OF 5 COLOURS:
BLACK • BLUE • GOLD • NATURAL • PURPLE HAZE

Flanged Hex Head

| Part Number | Thread Diameter/Pitch | Socket Size | Flange Diameter | Lengths Available |
|-------------|-----------------------|-------------|-----------------|---|
| TIHX4** | M4 x (0.70mm) | 6mm | 8mm | 10mm, 15mm, 25mm, 30mm |
| TIHX5** | M5 x (0.80mm) | 7mm | 10mm | 10mm, 12mm, 15mm, 20mm, 25mm |
| TIHX6** | M6 x (1.00mm) | 8mm | 12mm | 10mm, 12mm, 16mm, 18mm, 20mm, 22mm, 25mm, 28mm, 30mm, 32mm, 35mm, 40mm, 45mm, 50mm, 55mm, 60mm, 65mm, 70mm, 75mm, 80mm, 85mm, 90mm, 95mm, 100mm |
| TIHX780 | M7 x (1.00mm) | 8mm | 13mm | 80mm |
| TIHX8** | M8 x (1.25mm) | 12mm | 16mm | 15mm, 20mm, 25mm, 28mm, 30mm, 32mm, 35mm, 40mm, 45mm, 47mm, 49mm, 50mm, 55mm, 60mm, 65mm, 70mm, 85mm |
| TIHX10** | M10 x (1.50mm) | 12mm | 18mm | 20mm, 25mm, 30mm, 35mm, 40mm, 45mm, 50mm, 55mm, 60mm, 65mm |
| TIHX10**F | M10 x (1.25mm) | 12mm | 18mm | 25mm, 30mm, 35mm, 40mm, 45mm, 50mm, 55mm, 57mm, 60mm, 65mm, 70mm, 75mm, 80mm, 90mm, 110mm, 115mm |
| TIHX12**FF | M12 x (1.25mm) | 14mm | 20mm | 50mm, 55mm, 60mm, 65mm, 70mm, 75mm, 80mm |

Race Spec Hex Head Bolts

| Part Number | Thread Diameter/Pitch | Socket Size | Head Diameter | Lengths Available |
|-------------|-----------------------|-------------|---------------|--|
| TIHX5**R | M5 x (0.80mm) | 7mm | 10mm | 10mm, 12mm, 15mm, 18mm, 20mm, 25mm, 30mm, 40mm |
| TIHX6**R | M6 x (1.00mm) | 8mm | 11mm | 10mm, 12mm, 16mm, 18mm, 20mm, 22mm, 25mm, 28mm, 30mm, 32mm, 35mm, 40mm, 45mm, 50mm, 55mm, 60mm, 65mm, 70mm, 75mm, 80mm, 85mm, 90mm |
| TIHX720R | M7 x (1.00mm) | 8mm | 11mm | 20mm |
| TIHX8**R | M8 x (1.25mm) | 10mm | 15mm | 10mm, 15mm, 20mm, 25mm, 28mm, 30mm, 32mm, 35mm, 40mm, 45mm, 50mm, 55mm, 85mm |
| TIHX8**RXS | M8 x (1.25mm) | 10mm | 12.45 mm | 15mm, 20mm, 25mm, 30mm, 35mm, 40mm, 45mm |
| TIHX10**FR | M10 x (1.25mm) | 12mm | 17mm | 20mm, 25mm, 30mm, 35mm, 40mm, 45mm, 50mm, 55mm, 57mm, 60mm, 65mm, 70mm, 75mm, 80mm |
| TIHX1065R | M10 x (1.50mm) | 12mm | 17mm | 65mm |

Parallel Head Bolts

| Part Number | Thread Diameter/Pitch | Allen Key Drive | Head Diameter | Lengths Available |
|-------------|-----------------------|-----------------|---------------|--|
| TIPB5** | M5 x (0.80mm) | 4mm | 8mm | 10mm, 12mm, 16mm, 20mm, 25mm, 30mm |
| TIPB6** | M6 x (1.00mm) | 5mm | 10mm | 15mm, 20mm, 25mm, 30mm, 40mm, 45mm, 50mm |
| TIPB8** | M8 x (1.00mm) | 6mm | 12.5mm | 25mm, 30mm, 50mm |

** Denotes length to be selected / All length measurements are taken from below the head

Quick Release D-Ring

| Part Number | Description |
|-------------|---|
| TIQRCLIP17 | 17mm Titanium Quick Release Stud - D Ring |

Quick Release Allen Key Drive

| Part Number | Description |
|--------------|--|
| TIQRCLIPAK17 | 17mm Titanium Quick Release Stud - Allen Key |



PRO-BOLT RANGE - TITANIUM

TITANIUM BOLTS

ALL AVAILABLE IN A CHOICE OF 5 COLOURS:
BLACK • BLUE • GOLD • NATURAL • PURPLE HAZE

Dual Drive

| Part Number | Thread Diameter/Pitch | Head Height | Head Diameter | Socket Size | Allen Key size | Length Available |
|-------------|-----------------------|-------------|---------------|-------------|----------------|--|
| TIDD5**R | M5 x (0.80mm) | 5.50mm | 10mm | 7mm | 4mm | 10mm, 12mm, 15mm, 20mm, 25mm |
| TIDD6**R | M6 x (1.00mm) | 5.50mm | 12mm | 9mm | 5mm | 10mm, 12mm, 14mm, 16mm, 18mm, 20mm, 22mm, 25mm, 28mm, 30mm, 32mm, 35mm, 40mm, 45mm, 50mm, 55mm, 60mm, 65mm, 70mm, 75mm, 80mm, 85mm, 90mm |
| TIDD8**R | M8 x (1.25mm) | 7.50mm | 15mm | 11mm | 6mm | 10mm, 15mm, 20mm, 25mm, 28mm, 30mm, 32mm, 35mm, 40mm, 45mm, 50mm, 55mm |
| TIDD10**R | M10 x (1.25mm) | 9mm | 17mm | 12mm | 6mm | 20mm, 25mm, 30mm, 35mm, 40mm, 45mm, 50mm, 55mm, 57mm, 60mm, 65mm, 70mm, 75mm, 80mm |
| TIDD10**R | M5 x (1.50mm) | 9mm | 17mm | 12mm | 6mm | 65mm |



Torque Information

| Thread Diameter in mm | M5 | M6 | M8 | M10 |
|-----------------------|----|----|----|-----|
| Max Torque in NM | 9 | 15 | 45 | 50 |

Choice and Flexibility - Designed with an allen key drive, stronger than a standard socket cap bolt, yet maintaining the flexibility to opt for a socket wrench, provide choice and flexibility valued by GP, WSBK & BSB race teams worldwide. The response from race teams to the Pro-Bolt DualDrive™ has been unanimous resulting in its selection as the bolt of choice for many teams since its launch. **Strength by Design** - The DualDrive™ range is forged for superior strength after which the threads are rolled for greater fatigue strength and reduced galling. You can select the appropriate tool, depending on accessibility & torque required.

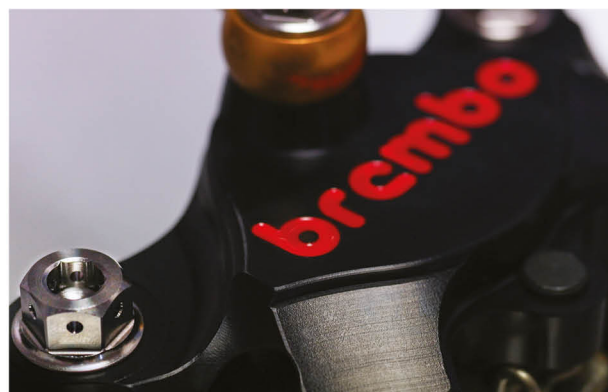
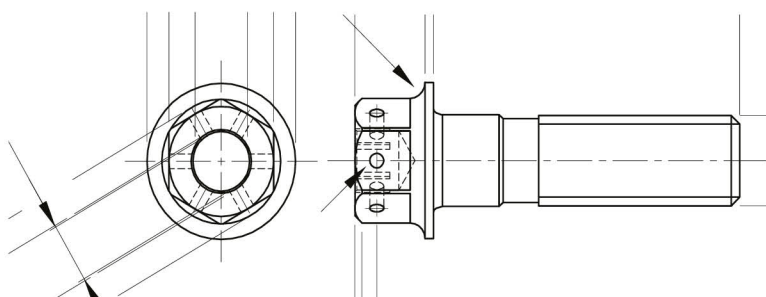

Fully Threaded/Dome Head Bolts

| Part Number | Thread Diameter/Pitch | Allen Key Drive | Max Head Diameter | Head Height | Lengths Available |
|-------------|-----------------------|-----------------|-------------------|-------------|-------------------|
| TIFBFT440 | M4 x (0.70mm) | 2.50mm | 8mm | 2.50mm | 40mm |
| TIFBFT540 | M5 x (0.80mm) | 4mm | 12mm | 3.50mm | 40mm |
| TIFBFT640 | M6 x (1.00mm) | 4mm | 16mm | 3.80mm | 40mm |

Fully Threaded/Countersunk Bolts

| Part Number | Thread Diameter/Pitch | Allen Key Drive | Max Head Diameter | Head Height | Lengths Available |
|-------------|-----------------------|-----------------|-------------------|-------------|-------------------|
| TICSFT440 | M4 x (0.70mm) | 2.50mm | 8mm | 2mm | 40mm |
| TICSFT540 | M5 x (0.80mm) | 3mm | 10mm | 3mm | 40mm |
| TICSFT640 | M6 x (1.00mm) | 4mm | 12mm | 3.50mm | 40mm |

Fully Threaded/Socket Cap Bolts

| Part Number | Thread Diameter/Pitch | Allen Key Drive | Max Head Diameter | Head Height | Lengths Available |
|-------------|-----------------------|-----------------|-------------------|-------------|-------------------|
| TISCFT440 | M4 x (0.70mm) | 3mm | 7mm | 4mm | 40mm |



TITANIUM NUTS

ALL AVAILABLE IN A CHOICE OF 5 COLOURS:
BLACK • BLUE • GOLD • NATURAL • PURPLE HAZE

Full Nuts

A

| Part No. | Thread Diameter/Pitch | Socket Size |
|----------|-----------------------|-------------|
| TIFN4 | M4 x (0.70mm) | 7mm |
| TIFN5 | M5 x (0.80mm) | 8mm |
| TIFN6 | M6 x (1.00mm) | 10mm |
| TIFN8 | M8 x (1.25mm) | 13mm |
| TIFN10 | M10 x (1.50mm) | 17mm |
| TIFN10F | M10 x (1.25mm) | 17mm |
| TIFN12F | M12 x (1.50mm) | 18mm |

Flanged Nuts

B

| Part No. | Thread Diameter/Pitch | Socket Size |
|------------|-----------------------|-------------|
| TIFLN3 | M3 x (0.50mm) | 5.50mm |
| TIFLN4 | M4 x (0.70mm) | 7mm |
| TIFLN5 | M5 x (0.80mm) | 8mm |
| TIFLN6 | M6 x (1.00mm) | 10mm |
| TIFLN6LEFT | M6 x (1.00mm) | 10mm |
| TIFLN8 | M8 x (1.25mm) | 13mm |
| TIFLN10 | M10 x (1.50mm) | 15mm |
| TIFLN10F | M10 x (1.25mm) | 14mm |
| TIFLN10FF | M10 x (1.00mm) | 14mm |
| TIFLN12 | M12 x (1.75mm) | 18mm |
| TIFLN12F | M12 x (1.50mm) | 17mm |
| TIFLN12FF | M12 x (1.25mm) | 17mm |

Nyloc Nuts

C

| Part No. | Thread Diameter/Pitch | Socket Size |
|----------|-----------------------|-------------|
| TINYN3 | M3 x (0.50mm) | 5.50mm |
| TINYN4 | M4 x (0.70mm) | 7mm |
| TINYN5 | M5 x (0.80mm) | 8mm |
| TINYN6 | M6 x (1.00mm) | 10mm |
| TINYN8 | M8 x (1.25mm) | 13mm |
| TINYN10 | M10 x (1.50mm) | 16mm |
| TINYN10F | M10 x (1.25mm) | 16mm |
| TINYN12 | M12 x (1.75mm) | 20mm |
| TINYN12F | M12 x (1.50mm) | 20mm |

Flanged Nyloc Nuts

D

| Part No. | Thread Diameter/Pitch | Socket Size |
|-------------|-----------------------|-------------|
| TINYNFL3 | M3 x (0.50mm) | 5.5mm |
| TINYNFL4 | M4 x (0.70mm) | 7mm |
| TINYNFL5 | M5 x (0.80mm) | 8mm |
| TINYNFL6 | M6 x (1.00mm) | 10mm |
| TINYNFL8 | M8 x (1.25mm) | 13mm |
| TINYNFL10 | M10 x (1.50mm) | 15mm |
| TINYNFL10F | M10 x (1.25mm) | 15mm |
| TINYNFL12 | M12 x (1.75mm) | 18mm |
| TINYNFL12F | M12 x (1.50mm) | 18mm |
| TINYNFL12FF | M12 x (1.25mm) | 18mm |

Flanged Bi-Hex Plastic Nyloc Nuts

E

| Part Number | Thread Diameter/Pitch | Socket Size |
|---------------|-----------------------|-------------|
| TINYNFLBH6 | M6 x (1.00mm) | 11mm |
| TINYNFLBH8 | M8 x (1.25mm) | 13mm |
| TINYNFLBH10 | M10 x (1.50mm) | 15mm |
| TINYNFLBH10F | M10 x (1.25mm) | 15mm |
| TINYNFLBH10FF | M10 x (1.00mm) | 15mm |

A



B



C



D



E



F



G



H



Flanged Metal Lock Nuts

F

| Part Number | Thread Diameter/Pitch | Socket Size |
|--------------|-----------------------|-------------|
| TILOCKNUT3 | M3 x (0.50mm) | 5.50mm |
| TILOCKNUT4 | M4 x (0.70mm) | 7mm |
| TILOCKNUT5 | M5 x (0.80mm) | 8mm |
| TILOCKNUT6 | M6 x (1.00mm) | 10mm |
| TILOCKNUT8 | M8 x (1.25mm) | 12mm |
| TILOCKNUT10 | M10 x (1.50mm) | 14mm |
| TILOCKNUT10F | M10 x (1.25mm) | 14mm |

Bi-Hex Metal Lock Nuts

G

| Part Number | Thread Diameter/Pitch | Socket Size |
|-----------------|-----------------------|-------------|
| TILOCKNUTBH6 | M6 x (1.00mm) | 11mm |
| TILOCKNUTBH8 | M8 x (1.25mm) | 13mm |
| TILOCKNUTBH10 | M10 x (1.50mm) | 14mm |
| TILOCKNUTBH10F | M10 x (1.25mm) | 14mm |
| TILOCKNUTBH10FF | M10 x (1.00mm) | 14mm |

Drilled Nuts

H

| Part No. | Thread Diameter/Pitch | Socket Size |
|-----------|-----------------------|-------------|
| TIFLN8D | M8 x (1.25mm) | 12mm |
| TIFLN10FD | M10 x (1.25mm) | 14mm |

PRO-BOLT RANGE - TITANIUM

TITANIUM WASHERS

ALL AVAILABLE IN A CHOICE OF 5 COLOURS:
BLACK • BLUE • GOLD • NATURAL • PURPLE HAZE

Flat Washers

| Part Number | Inner Diameter | Outside Diameter | Thickness |
|-------------|----------------|------------------|-----------|
| TIWA3 | M3 | 7mm | 0.60mm |
| TIWA4 | M4 | 9mm | 0.70mm |
| TIWA5 | M5 | 10mm | 1.00mm |
| TIWA6 | M6 | 12mm | 1.50mm |
| TIWA8 | M8 | 16mm | 1.60mm |
| TIWA10 | M10 | 20mm | 1.70mm |
| TIWA12 | M12 | 24mm | 2.60mm |



Penny Washers

| Part Number | Inner Diameter | Outside Diameter | Thickness |
|-------------|----------------|------------------|-----------|
| TIWA5-15 | M5 | 15mm | 1.00mm |
| TIWA5-20 | M5 | 20mm | 1.00mm |
| TIWA6-15 | M6 | 15mm | 1.50mm |
| TIWA6-20 | M6 | 20mm | 1.50mm |
| TIWA6-25 | M6 | 25mm | 1.80mm |



Countersunk Washers

| Part Number | Inner Diameter | Outside Diameter | Thickness |
|-------------|----------------|------------------|-----------|
| TIWAC6-22 | M6 | 22mm | 4.50mm |



Drilled Washers

| Part Number | Inner Diameter | Outside Diameter | Thickness |
|-------------|----------------|------------------|-----------|
| TIWAD5 | M5 | 10mm | 1.00mm |
| TIWAD6 | M6 | 12mm | 1.50mm |
| TIWAD8 | M8 | 16mm | 1.60mm |
| TIWAD10 | M10 | 20mm | 1.70mm |
| TIWAD12 | M12 | 24mm | 2.50mm |



Aluminium Threaded Collars/Spacers

| Part Number | Description |
|----------------|--|
| LCOLLAR5-7-3U | 5mm Threaded Collar - 7.5mm o/d - 3mm in Length |
| LCOLLAR5-7-5U | 5mm Threaded Collar - 7.5mm o/d - 5mm in Length |
| LCOLLAR5-7-10U | 5mm Threaded Collar - 7.5mm o/d - 10mm in Length |
| LCOLLAR6-8-3U | 6mm Threaded Collar - 8mm o/d - 3mm in Length |
| LCOLLAR6-8-5U | 6mm Threaded Collar - 8mm o/d - 5mm in Length |
| LCOLLAR6-10-3U | 6mm Threaded Collar - 10.5mm o/d - 3mm in Length |
| LCOLLAR6-10-6U | 6mm Threaded Collar - 10.5mm o/d - 6mm in Length |
| LCOLLAR8-10-5U | 8mm Threaded Collar - 10mm o/d - 5mm in Length |

Copper Washers

| Part Number | Description |
|-------------|------------------|
| LWCOP10 | M10 x 13.5mm o/d |
| LWCOP14-19 | M14 x 19mm o/d |

Plastic Anti Scratch Washers

| Part Number | Description |
|-------------|--|
| LWAN4 | M4 Plastic Washer for Domehead Bolt |
| LWAN5 | M5 Plastic Washer for Domehead Bolt |
| LWAN6 | M6 Plastic Washer for Domehead Bolt |
| LWAN8 | M8 Plastic Washer for Domehead Bolt |
| LWACR6 | M6 Plastic Washer for Countersunk Washer |
| LWACR8 | M8 Plastic Washer for Countersunk Washer |

Quick Release Spring/Cup Washers

| Part Number | Description |
|-------------|--|
| LWARQR | Flat Plastic Washer for Quick Release Stud |
| LWASQR | Steel 'Grippa' Washer for Quick Release Fastener |
| QRSRING | Quick Release Spring & Washers |

Plastic Tubing/Spacing Collars

| Part Number | Description |
|-------------|------------------|
| TUB5 | M5 Spacer/Tubing |
| TUB6 | M6 Spacer/Tubing |



ANCILLARY ITEMS

Backing Plates & Receptacles

| Part Number | Description |
|-------------|---|
| CLIP1 | M6 Chimney Nut / Slip On |
| CLIP2 | M5 Chimney Nut / Slip On - 14mm width |
| CLIP3 | Receptacle for Quick Release - Slide On |
| CLIP4 | M8 Chimney Nut / Slip On |
| CLIP5 | M5 Chimney Nut / Slip On - 12mm width |
| CLIP6 | Receptacle for Quick Release - Rivet On |
| CLIP7 | M5 Chimney Nut / Weld On |
| CLIP8 | M6 Chimney Nut / Weld On |
| CLIP9 | Race Fairing S Clip |
| CLIP20 | Race Fairing S Clip - Pack of 20 |
| LRIVET3.2-6 | Blind rivet 3.2mm diameter x 6mm length |
| LWARQR | Plastic Washer for Quick Release Stud |
| LWASQR | Steel Grippa Washer for M6 Quick Release Stud |

Allen Keys

| Part Number | Description |
|-------------|-----------------|
| AK1.5 | 1.5mm Allen Key |
| AK2 | 2mm Allen Key |
| AK2.5 | 2.5mm Allen key |
| AK3 | 3mm Allen Key |
| AK4 | 4mm Allen Key |
| AK5 | 5mm Allen Key |
| AK6 | 6mm Allen Key |

Lockwire

For use with both our Race Spec and DualDrive range of fasteners, we offer 302 grade stainless steel lockwire supplied by the roll or the meter.

| Part Number | Description |
|-----------------|-------------------------------------|
| LOCKWIRE.51 | 0.51mm Diameter x 1 Meter Length |
| LOCKWIRE.51ROLL | 0.51mm Diameter x 1 Roll 0.45 kilos |
| LOCKWIRE.61 | 0.61mm Diameter - 1 Meter Length |
| LOCKWIRE.61ROLL | 0.61mm Diameter - 1 Roll 0.45 kilos |

Rubber Well Nuts

| Part Number | Description | Thread Pitch |
|-------------|-----------------------------|--------------|
| LRNUT4F | M4 Rubber Nut | 0.50mm |
| LRN4 | M4 Rubber Nut - 11mm Length | 0.70mm |
| LRN5 | M5 Rubber Nut - 13mm Length | 0.80mm |
| LRN6 | M6 Rubber Nut - 15mm Length | 1.00mm |
| LRN6-25 | M6 Rubber Nut - 25mm Length | 1.00mm |
| LRN8 | M8 Rubber Nut - 28mm Length | 1.00mm |

Copper Grease

Prevent galling when fitting titanium fasteners using copper grease supplied in a 5ml sachet.



Nylon Pry and Push Rivets

| Part Number | Description |
|-------------|----------------------------|
| PBPRYRIV7 | Nylon Black Pry Rivet M7 |
| PBPRYRIV8 | Nylon Black Pry Rivet M8 |
| PBPUSHRIV6 | Nylon Black Push Rivet M6 |
| PBPUSHRIV7 | Nylon Black Push Rivet M7 |
| PBPUSHRIV8 | Nylon Black Push Rivet M8 |
| PBSCREWIV6 | Nylon Black Screw Rivet M6 |

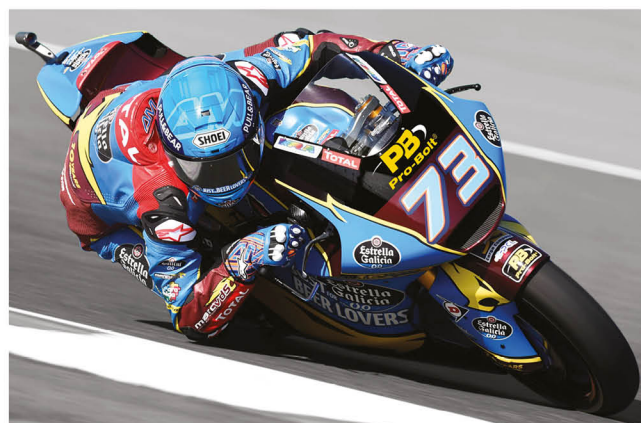



PRO-BOLT WORLDWIDE

Pro-Bolt have a worldwide distribution network and a network of websites serving customers. Our websites enable customers to discuss and enquire about our products with a local representative, and see pricing in their local language and currency.

EUROPE

| | |
|-------------|--|
| EU | www.probolt-eu.com |
| France | www.probolt-france.com |
| Germany | www.probolt-germany.com |
| Italy | www.probolt-italy.com |
| Switzerland | www.pro-bolt.ch |

NORTH & SOUTH AMERICA

| | |
|---------|--|
| America | www.probolt-usa.com |
|---------|--|

AFRICA

| | |
|--------------|--|
| South Africa | www.probolt-southafrica.com |
|--------------|--|

AUSTRALIA & NEW ZEALAND

| | |
|-----------|--|
| Australia | www.probolt-australia.com |
|-----------|--|

MIDDLE/FAR EAST

| | |
|-------|--|
| Japan | www.probolt-japan.com |
|-------|--|

SOUTH EAST ASIA

| | |
|----------|--|
| Thailand | www.thailand.probolt.com |
|----------|--|

ProBolt Fasteners Ltd, Unit 9D, Delta Drive Industrial Estate , Tewkesbury, Gloucestershire, GL20 8HB, United Kingdom

Tel: 0044 (0)1684 851940 Email: sales@pro-bolt.com

Online: www.pro-bolt.com